

EN Petrol Lawnmower  
140 cm<sup>3</sup>, 46 cm

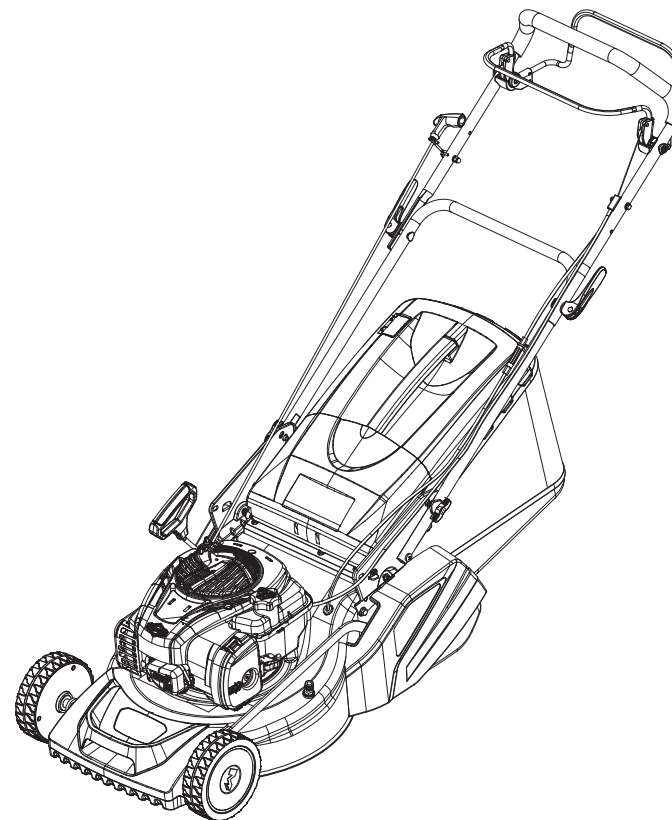

**Manufacturer:**  
**UK Manufacturer:**  
Kingfisher International Products Limited,  
1 Paddington Square, London, W2 1GG,  
United Kingdom

**EU Manufacturer:**  
Kingfisher International Products B.V.  
Rapenburgerstraat 175E  
1011 VM Amsterdam  
The Netherlands  
[www.kingfisher.com/products](http://www.kingfisher.com/products)

**EN** [www.diy.com](http://www.diy.com)  
[www.screwfix.com](http://www.screwfix.com)  
[www.screwfix.ie](http://www.screwfix.ie)  
**To view instruction manuals online,**  
**visit [www.kingfisher.com/products](http://www.kingfisher.com/products)**

**EN ORIGINAL INSTRUCTIONS**

**IMPORTANT** - These instructions are for your safety.  
Please read through them thoroughly prior to handling  
the product and retain them for future reference.



V11022\_5063022057501\_MAND1\_2223

**MLMP500SP46-ROL**  
**5063022057501**

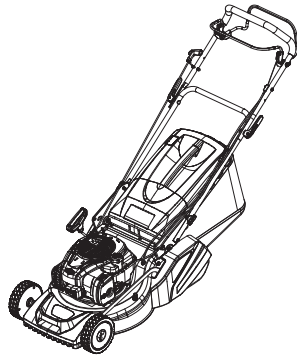

01. x1

EN You will need

x1



EN Contents

EN	
Product description	3
Safety	5
Technical specifications	16
Before you start	17
Use	23
Functions & Settings	25
Operation	29
Care and maintenance	33
Guarantee	43

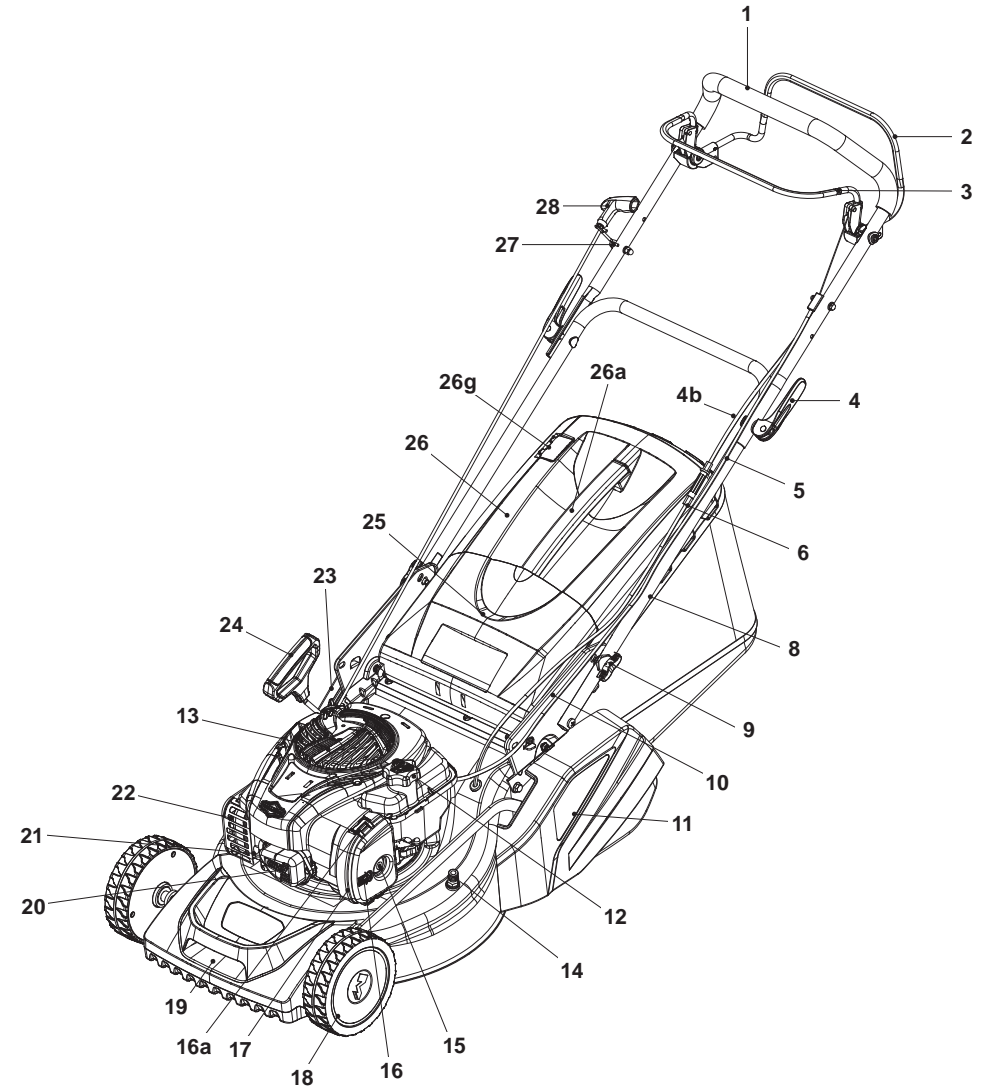

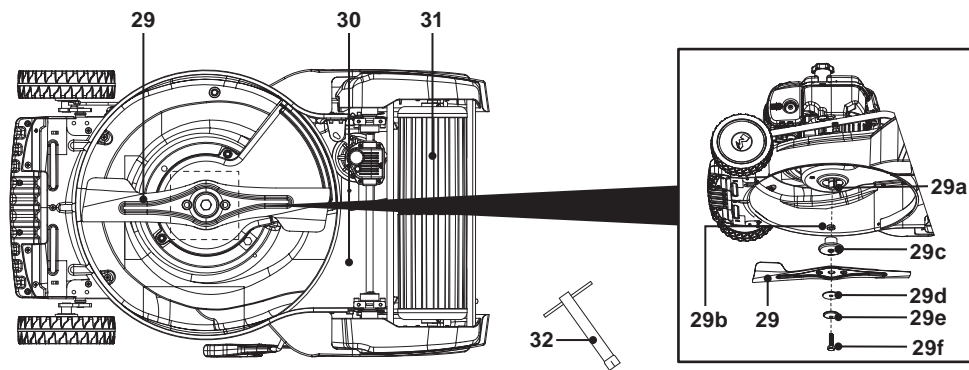

- |                          |   |                                    |
|--------------------------|---|------------------------------------|
| 1. Upper handle bar      | 16. Air filter cover                    | 27. Hook for recoil starter handle |
| 2. Self-propelling lever | a. Locking latch (x2)                   | 28. Recoil starter handle          |
| 3. Brake lever           | b. Filter*                              | 29. Cutting device (blade)         |
| 4. Clamp lever (x2)      | 17. Carburetor*                         | a. Spindle                         |
| a. Washer*               | a. Fuel drain screw*                    | b. Inner bushing                   |
| b. Mounting bolt         | 18. Front wheel (x2)                    | c. Blade holder                    |
| 5. Brake wire            | 19. Transport handle                    | d. Locking flange with pins        |
| 6. Self-propelling wire  | 20. Engine                              | e. Cup washer                      |
| a. Locking nut*          | 21. Spark plug connector                | f. Hex bolt                        |
| b. Sleeve*               | a. Spark plug*                          | 30. Rear discharge chute           |
| 8. Lower handle bar      | 22. Muffler                             | 31. Rear roller                    |
| a. Mounting hole* (x4)   | 23. Oil tank cap                        | 32. Spark plug wrench              |
| 9. Locking knob (x2)     | 24. Lever for cutting height adjustment |                                    |
| a. Auto-tension pin*     | 25. Rear deflector guard                |                                    |
| 10. Handle bracket (x2)  | 26. Grass catcher                       |                                    |
| a. Mounting hole* (x3)   | a. Carry handle                         |                                    |
| 11. Roller deck (x2)     | b. Rubber clips* (x3)                   |                                    |
| 12. Fuel tank cap        | c. Hook* (x2)                           |                                    |
| 13. Air vents            | d. Protective cap* (x2)                 |                                    |
| 14. Water inlet          | e. Rod*                                 |                                    |
| 15. Primer               | f. Bottom handle*                       |                                    |
|                          | g. Hatch                                |                                    |



**NOTE:** Parts marked with \* are not shown in this overview. Please refer to the respective section in the instruction manual.



EN Safety

## Petrol powered lawnmowers safety warnings



**IMPORTANT**

Read carefully before use.



Keep for future reference.



**WARNING!** Your safety and the safety of others is very important. Of course, it is not practical or possible to warn you about all the hazards associated with operating or maintaining this product. At all times you must use your own good judgment.

## Training

1. Read the instructions carefully. Be familiar with the controls and the proper use of the product.
2. Never allow children or people unfamiliar with these instructions to use the product. Local regulations can restrict the age of the operator.
3. Never mow while people, especially children, or pets are nearby.
4. Keep in mind that the operator or user is responsible for accidents or hazards occurring to other people or their property.
5. The operators must receive proper training in the use, adjustment and operation of the product, including prohibited operations.

## Preparation

1. While mowing, always wear substantial footwear and long trousers. Do not operate the product when barefoot or wearing open sandals.
2. Thoroughly inspect the area where the product is to be used and remove all objects which can be thrown by the product.



**WARNING!** Petrol is highly flammable.

- Store fuel in containers specifically designed for this purpose.
  - Refuel outdoors only and do not smoke while refuelling.
  - Add fuel before starting the engine. Never remove the fuel tank cap or add petrol while the engine is running or when the engine is hot.
  - If petrol is spilt, do not attempt to start the engine but move the product away from the area of spillage and avoid creating any source of ignition until petrol vapours have dissipated.
  - Replace all fuel tank and container caps securely.
3. Replace faulty silencers.
  4. Before using, always visually inspect to see that the cutting devices, cutting device bolts and cutter assembly are not worn or damaged. Replace worn or damaged cutting devices and bolts in sets to preserve balance.



**CAUTION!** Do not touch rotating cutting device.

5. Engine brake (brake lever (3)): Use the brake lever (3) to stop the engine. When you release the brake lever (3), the engine and the blade stop automatically in a few second. To mow, hold the brake lever (3) in the working position. Before you start to mow, check the brake lever (3) several times to be sure that it is working properly. Ensure that the brake wire (5) can be smoothly operated (i.e. is not catching or kinking in any way).

## Operation

1. Do not operate the engine in a confined space where dangerous carbon monoxide fumes can collect.
2. Mow only in daylight or in good artificial light.
3. Do not operate the product when there is a risk for lightning.

4. Do not operate the product while being tired, ill or under influence of alcohol or drugs.
5. Avoid operating the product in wet grass, where feasible.
6. Always be sure of your footing on slopes.
7. Walk, never run.
8. Mow across the face of slopes, never up and down.
9. Exercise extreme caution when changing direction on slopes.
10. Do not mow excessively steep slopes near drop-offs, ditches or embankments.
11. Avoid using the product in bad weather conditions especially when there is a risk of lightning.
12. Use extreme caution when reversing or pulling the product towards you.
13. Stop the cutting device(s) if the product has to be tilted for transportation when crossing surfaces other than grass, and when transporting the product to and from the area to be mowed.
14. Never operate the product with defective guards, shields, or without safety devices, for example deflectors and/or grass catchers, in place.
15. Do not change the engine governor settings or overspeed the engine.
16. Do not alter or tamper with any sealed adjustments for the engine speed control.
17. Do not tamper or disable any product's safety systems or features.
18. Ensure and regularly check that all starting interlocks and operator presence controls are properly functioning.
19. Stop the product according to instructions in this manual before leaving the operator's position and park it in a safe location.
20. Start the engine or switch on the engine carefully according to instructions and with feet well away from the cutting device(s).



21. Do not tilt the product when starting the engine or switching on the engine, except if the product has to be tilted for starting. In this case, do not tilt it more than absolutely necessary and lift only the part which is away from the operator. Always ensure that both hands are in the operating position before returning the appliance to the ground.
22. Keep hands and feet away from the cutting means at all times and especially when switching on the engine.
23. Do not put hands or feet near or under rotating parts. Keep clear of the discharge opening at all times.
24. Never pick up or carry a product while the engine is running.
25. In case of any situation mentioned below, stop the engine and disconnect the spark plug connector, make sure that all moving parts have come to a complete stop and, where a key is fitted remove the key:
  - before clearing blockages or unclogging chute,
  - before checking, cleaning or working on the product,
  - after striking a foreign object. Inspect the product for damage
  - and make repairs before restarting and operating the product,
  - if the product starts to vibrate abnormally (check immediately).
    - > inspect for damage
    - > replace or repair any damaged parts
    - > check for and tighten any loose parts
  - whenever you leave the product,
  - before refuelling.
26. Never touch the exhaust, exhaust guard or cooling fins when the engine is hot.
27. Never carelessly touch hot parts of the product, you can burn yourself. While the product is in operation or shortly thereafter, its parts such as the exhaust pipe, engine, and other surfaces are extremely hot! Pay attention to the markings on the product.
28. Make sure that the air vents of the combustion engine are clear. Keep the air vents free of dust, dirt particles, gases and fumes.

29. Never start or run the engine indoors. The exhaust fumes are dangerous, containing carbon monoxide, an odourless and deadly gas. Operate this product only in well ventilated outdoor areas.

## Maintenance and storage

1. Follow the maintenance and repair instructions for this product. Never carry out any modifications of the product. Never change the preset rotary speed or the engine and product settings. Information about maintenance and repair is provided in this user manual.
2. Keep all nuts, bolts and screws tight to be sure the product is in safe working condition.
3. Improper maintenance, using non-genuine parts, or removing / modifying safety components may lead to malfunction / failure of the product and injury of operators. Many accidents are caused by poorly maintained products.
4. Never store the product with petrol in the tank inside a building where fumes can reach an open flame or spark.
5. To reduce the fire hazard, keep the engine, silencer and petrol storage area free of grass, leaves, or excessive grease to reduce the fire hazard.
6. Allow the engine to cool before storing in any enclosure. Clean and maintain the product before storage.
7. Check the grass catcher frequently for wear or deterioration.
8. If the fuel tank has to be drained, this should be done outdoors.
9. Wear strong work gloves when removing and re-assembling the cutting device.
10. Replace worn or damaged parts for safety. Use only the genuine replacement parts and spare parts.
11. Ensure that only replace the recommended cutting means (blade) with the right type.

## Fuel handling

1. Before refuelling, stop the engine, disconnect the spark plug connector and let the product cool. Fuel and fuel vapours are highly flammable. Take care when handling fuel. Never smoke when you are refuelling the product. Do not refuel the product, if there is an open fire in the vicinity!
2. Always use suitable aids such as funnels and filler necks. Do not spill any fuel on the product or its exhaust system. There is a risk of ignition. However, if fuel should be spilled, then you must remove it carefully from all parts of the product. Any residue which may be present must be completely removed, before the product is operated!
3. Never refuel indoors. Exhaust gases and fuel fumes are noxious.
4. Never use the product in environments where there is a risk of explosion. Fuel fumes can ignite.
5. Never breathe in any fuel fumes, when you are refuelling the product. Never fill the tank in enclosed spaces, such as basements or sheds. There is a risk of poisoning and explosion!
6. Avoid skin contact with petrol.
7. Do not eat or drink, while you are refuelling the product. If you have swallowed petrol or oil, or if petrol or oil has got into your eyes, then seek medical advice immediately.
8. Close the fuel tank cap immediately after filling the fuel tank. Make sure that it is properly closed.
9. Never use the product without an air filter.
10. Fuel vapour pressure may build up inside the fuel tank depending on the fuel used, weather conditions and the tank venting system. To reduce the risk of burns and other personal injuries, remove the fuel cap carefully to allow any pressure build up to release slowly.
11. Be aware of fire risks, explosion and inhalation risks.
12. Do not smoke while operating the product, handling fuel or near fuel.

13. Ensure the spark plug lead is secured; a loose lead may cause electrical arcing that could ignite combustible fumes and cause a fire or explosion.
14. Check regularly for leaks from the fuel cap and fuel lines.
15. Do use caution when handling fuel. To avoid any accidental fires, move the product at least 3 metres (10') from the fuelling point before starting the engine.
16. Tighten the fuel tank cap thoroughly after refilling the fuel tank.
17. Do not operate the product if it is leaking fuel. Do not remove the fuel tank cap while the engine is running.
18. Use only an approved container for this purpose.
19. Do not store cans of fuel or refill the fuel tank in any place where there is a boiler, stove, wood fire, electrical sparks, welding sparks, or other sources of heat or fire which might ignite the fuel.
20. If any fuel spillage occurs during refuelling, use a dry rag to wipe up spills and allow remaining fuel to evaporate before turning the engine on again.
21. If you have spilt fuel on yourself or on your clothes, change your clothes and wash any part of your body that has come in contact with fuel before turning the engine on again.
22. If fuel is ignited, put out the fire with a dry powder fire extinguisher.
23. If the fuel tank is drained, this should be done outdoors.

## Vibration and noise reduction

**To reduce the impact of noise and vibration emission, limit the time of operation, use low-vibration and low-noise operating modes as well as wear personal protective equipment.**

Take the following points into account to minimize the vibration and noise exposure risks:

1. Only use the product as intended by its design and these instructions.
2. Ensure that the product is in good condition and well maintained.
3. Use correct attachments for the product and ensure they are in good condition.

4. Keep tight grip on the handles/gripping surface.
5. Maintain this product in accordance with these instructions and keep it well lubricated (where appropriate).
6. Plan your work schedule to spread any high vibration tool use across a longer period of time.

## Emergency

**Familiarise yourself with the use of this product by means of this instruction manual. Memorise the safety directions and follow them to the letter. This will help to prevent risks and hazards.**

1. **Always be alert when using this product, so that you can recognize and handle risks early.** Fast intervention can prevent serious injury and damage to property.
2. **Stop the engine and disconnect the spark plug connector if there are malfunctions.** Have the product checked by a qualified professional and repaired, if necessary, before you operate it again.
3. **In case of fire stop the engine and disconnect the spark plug connector.** Take fire-extinguishing measures immediately if the product switch is no longer accessible.

 **WARNING!** Never use water to extinguish a product on fire. Burning fuel must be extinguished with special extinguishing agents! We recommend that you keep a suitable fire extinguisher within reach in your work area!

## Residual risks

**Even if you are operating this product in accordance with all the safety requirements, potential risks of injury and damage remain. The following dangers can arise in connection with the structure and design of this product:**

1. Health defects resulting from vibration emission if the product is being used over long periods of time or not adequately managed and properly maintained.

2. Injuries and damage to property due to broken application tools or the sudden impact of hidden objects during use.
3. Danger of injury and property damage caused by flying objects.
4. Burns, if touching hot surfaces.



**WARNING!** This product produces an electromagnetic field during operation! This field may under some circumstances interfere with active or passive medical implants! To reduce the risk of serious or fatal injury, we recommend persons with medical implants to consult their doctor and the medical implant manufacturer before operating this product!

## Symbols

On the product, the rating label and within these instructions you will find among others the following symbols and abbreviations. Familiarise yourself with them to reduce hazards like personal injuries and damage to property.

kW	Kilowatt	ml	Millilitre
cm <sup>3</sup>	Cubic centimetre	g/kWh	Gram per kilowatt per hour
/min or min <sup>-1</sup>	Per minute	kg/h	Kilogram per hour
mm	Millimetre	°C	Degree Celsius
cm	Centimetre	dB(A)	Decibel (A-rated)
kg	Kilogram	m/s <sup>2</sup>	Metres per second squared
l	Litre		
yyWxx	Manufacturing date code; year of manufacturing (yy) and week of manufacturing (Wxx)		



Lock/to tighten or secure.



Unlock/to loosen.



**CAUTION!**  
**WARNING!**  
**DANGER!**



**CAUTION / WARNING!**  
Read the instruction manual.



**NOTE:**



Wear hearing protection. Wear eye protection.



Wear respiratory protection.



Wear protective gloves.



Wear protective, slip-resistant footwear.



Wear tight-fitted protective clothes.



Do not expose the product to rain or wet conditions.



Open flames in the work area, around the product and in the vicinity of flammable materials are prohibited!



**Do not smoke** in the work area, around the product and in the vicinity of flammable materials!



**Risk of fire / flammable materials**



Hot surface, do not touch! High temperatures on the product's surfaces and structural parts that could cause burns, if they are touched. The product can also stay hot for a longer period of time after operation!



This product produces noxious exhaust fumes. If the product is used improperly, these fumes can lead to poisoning, a loss of consciousness or death!



Noxious exhaust fumes; do not operate or start the product in indoor rooms!



Keep hands and feet away.



**CAUTION / WARNING!**



Only refuel unleaded petrol!



Add engine oil.



Check and refill oil.



Switch the engine off while you are refilling the tanks!

Fuel is flammable, keep fire away. Do not add fuel with running engine.



Mow across the face of slopes, never up and down.



Inspect the area where the product is to be used and remove all objects which can be thrown by the product.

If objects are hidden while operating, stop the engine and remove the object.



Keep hands and feet away from sharp rotating parts - danger of injury! When cleaning, repairing, or inspecting, make certain the cutting device and all mowing parts have stopped. Disconnect the spark plug connector, and keep the connector away from the plug to prevent accidental starting.



Stop the engine and disconnect the spark plug connector before assembly, cleaning, adjustments, maintenance, storage and transportation.



Cutting device continues to rotate after the product is switched off. Wait until all machine components have completely stopped before touching the product.



Pay special attention when working on the cutting device!



Objects thrown by the product could hit the user or other bystanders. Always ensure that other people and pets remain at a safe distance from the product when it is in operation. In general, children must not come near the area where the product is.



Objects thrown by the product could hit the user or other bystanders. Always ensure that other people and pets remain at a safe distance from the product when it is in operation. In general, children must not come near the area where the product is.



Release the brake lever (3) to stop the engine and blade.



Push the self-propelling lever (2) forward to engage the rear roller (31).



Engine manual start; recoil starter.



Press the primer three times.



Guaranteed sound power level value in 96 dB.



Grass catcher is ready for grass collection.



Grass catcher is full, empty it.



The product complies with the applicable European directives and an evaluation method of conformity for these directives was done.

**Rating label explanation**

**Petrol Lawn Mower: MLMP500SP46-ROL**

M = MAC Allister

LM = Lawn Mower

P = Petrol

500 = Briggs & Stratton engine mode

SP = Self Propelling

46 = Cutting width (cm)

ROL = Roller

## EN Technical specifications

### General

> <b>Dimensions</b>	: 1560 x 560 x 1000 mm
> <b>Machine mass with empty tanks and in normal operating configuration</b>	: approx. 30.9 kg
> <b>Fuel tank capacity</b>	: 800 ml (cm <sup>3</sup> )
> <b>Petrol type</b>	: #95, unleaded
> <b>Engine oil capacity</b>	: 470 ml (cm <sup>3</sup> )
> <b>Engine oil type</b>	: 4-stroke engine oil (e.g. SAE 10W-30)
> <b>Drive type</b>	: Self-propelled with rear roller
> <b>Specific fuel consumption at max. engine power</b>	: 319 g/kWh
> <b>Fuel consumption at max. engine power</b>	: 0.88 kg/h
> <b>Cutting device</b>	: 2105200347, Thickness 2.5 mm
> <b>Cutting width</b>	: 46 cm
> <b>Cutting height</b>	: 20-75 mm, 7 levels
> <b>Grass catcher volume</b>	: 55 l

### Engine

> <b>Engine model</b>	: Briggs&Stratton, BS500E
> <b>Engine type</b>	: air cooled, 4-stroke engine
> <b>Engine displacement</b>	: 140 cm <sup>3</sup>
> <b>Rated engine speed</b>	: 2800 min <sup>-1</sup>
> <b>Maximum operating engine speed (rotational frequency)</b>	: 2800 min <sup>-1</sup>
> <b>Nominal power</b>	: 1.9 kW
> <b>Spark plug type</b>	: XC92YC / 797429
> <b>Spark plug gap</b>	: 0.7-0.8 mm

### Sound level

> <b>Sound pressure level at operator's position L<sub>pA</sub></b>	: 81.2 dB(A)
> <b>Uncertainty K<sub>pA</sub></b>	: 3 dB(A)
> <b>Sound power level L<sub>WA</sub></b>	: 94.2 dB(A)
> <b>Uncertainty K<sub>WA</sub></b>	: 1.98 dB(A)
> <b>Guaranteed sound power level L<sub>WA</sub> (acc. to 2000/14/EC amended by 2005/88/EC)</b>	: 96 dB(A)

### Vibration level

> <b>Hand arm vibration a<sub>hw</sub></b>	: 4.36 m/s <sup>2</sup>
> <b>Uncertainty K</b>	: 1.5 m/s <sup>2</sup>

The sound values have been determined according to noise test code given in EN ISO 5395-1 and EN ISO 5395-2, using the basic standards ISO 3744 and ISO 11094.

Wear hearing protection, especially when sound pressure is over 80 dB(A).

The declared vibration value has been measured in accordance with a standard test method (according to EN ISO 5395-1 and EN ISO 5395-2) and may be used for comparing one product with another. The declared vibration value may also be used to evaluate the exposure for the user caused by vibration in advance.



**WARNING!** Depending on the actual use of the product the vibration values can differ from the declared total! Adopt proper measures to protect yourself against vibration exposures. Take the whole work process including times the product is running under no load or switched off into consideration.

Proper measures include among others regular maintenance and care of the product and application tools, keeping hands warm, periodical breaks and proper planning of work processes.

## EN Before you start

### Unpacking



**NOTE:** The product is heavy, ask another person for assistance if required.

1. Unpack all parts and lay them on a flat, stable surface.
2. Remove all packing materials and shipping devices, if applicable.
3. Make sure the delivery contents are complete and free of any damage. If you find that parts are missing or show damage do not use the product but contact your dealer. Using an incomplete or damaged product represents a hazard to people and property.
4. Ensure that you have all the accessories and tools needed for assembly and operation. This also includes suitable personal protective equipment.



**WARNING!** The product and the packaging are not children's toys! Children must not play with plastic bags, sheets and small parts! There is a danger of choking and suffocation!

### You will need

#### (items not supplied)

Suitable personal protective equipment  
Fuel funnel with filter  
Petrol and engine oil  
Fuel collecting container  
Oil collecting container  
Lubrication oil/grease  
Suitable torque wrench  
Suitable spanner

#### (items supplied)

Grass catcher (**26**)  
Spark plug wrench (**32**)  
Briggs & Stratton (B&S) operator's manual



## Assembly



**WARNING!** The product must be fully assembled before operation! Do not use a product that is only partly assembled or assembled with damaged parts!



Follow the assembly instructions step-by-step and use the pictures provided as a visual guide to easily assemble the product!

Disconnect the spark plug connector (21) from the spark plug! Reconnect it after assembly.



**NOTE:** Take care of small parts that are removed during assembly or when making adjustments. Keep them secure to avoid loss.

## Lower handle bar

1. Put the product on the ground.
2. Loosen the two locking knobs (9) 90° anti-clockwise from the handle brackets (10) and the lower handle bar (8) (Fig. 1).
3. Align the mounting holes (8a, 10a) of the lower handle bar (8) with the two handle brackets (10), then turn the two locking knobs (9) 90° clockwise (Fig. 2, step 1).
4. If necessary, press the locking knob (9) to make sure that the auto-tension pin (9a) passes through the mounting holes (8a, 10a) of the lower handle bar (8) and handle bracket (10) on both sides (Fig. 2, step 2).



**NOTE:** There are three mounting holes (10a) in the handle brackets (10). Ensure that the lower handle bar (8) is assembled on the same height level on both sides of the handle brackets (10).

1. Make sure that the brake wire (5) and the self-propelling wire (6) run on the upper side of the lower handle bar (8).

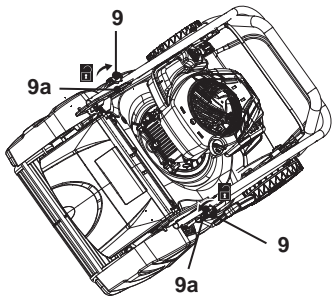

Fig. 1

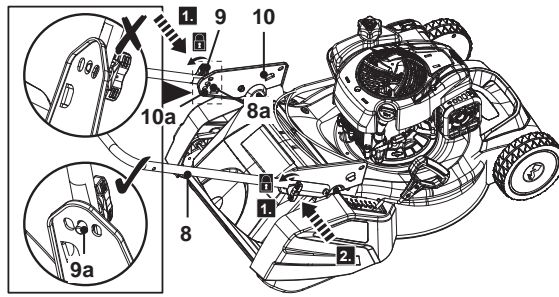

Fig. 2

## Upper handle bar

1. Align the mounting holes of the upper handle bar (1) and the lower handle bar (8). Ensure that the upper handle bar (1) with the brake lever (3) facing upwards.
2. Pass the mounting bolt (4b) through the mounting holes to the end (Fig. 3, step 1), then attach the washer (4a) and the clamp lever (4).
3. Secure the upper handle bar (1) with the lower handle bar (8) by folding up the clamp levers (4) towards the handle bars (1, 8). If the clamp lever (4) cannot be folded, loosen it and fold again. If it is too loose, tighten it by turning the clamp lever (4) clockwise (Fig. 3, step 2).
4. Make sure that the pre-assembled hook for recoil start handle (27) rest on your right-hand side (when viewed from operator's position).

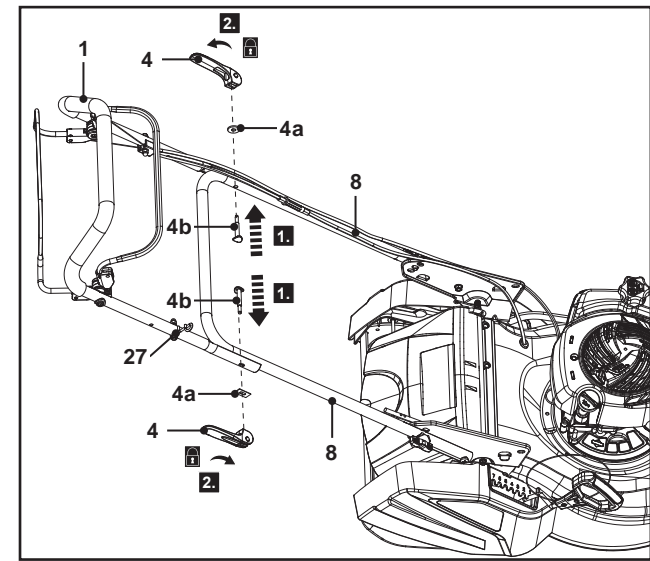

Fig. 3

5. Attach the brake wire (5) and the self-propelling wire (6) on the left-hand side of the lower handle bar (8) (when viewed from operator's position) (Fig. 4).

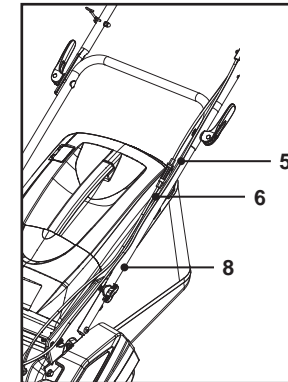

Fig. 4

## Grass catcher

1. Attach the rubber clips (26b) to the rod (26e) if they are not pre-assembled.
2. Remove the two protective caps (26d) from the hooks (26c) (Fig. 5)
3. The grass catcher (26) is now ready for use.

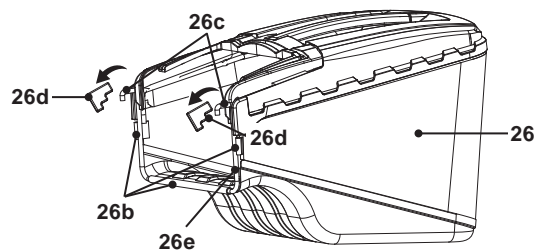

Fig. 5

4. Open the rear deflector guard (25) and hold it in position (Fig. 6, step 1).
5. Carry the grass catcher by its carry handle (26a).
6. Align the hooks (26c) with the spring rod and hang the grass catcher onto it (Fig. 6, step 2).
7. Carefully release the rear deflector guard (25) afterwards.

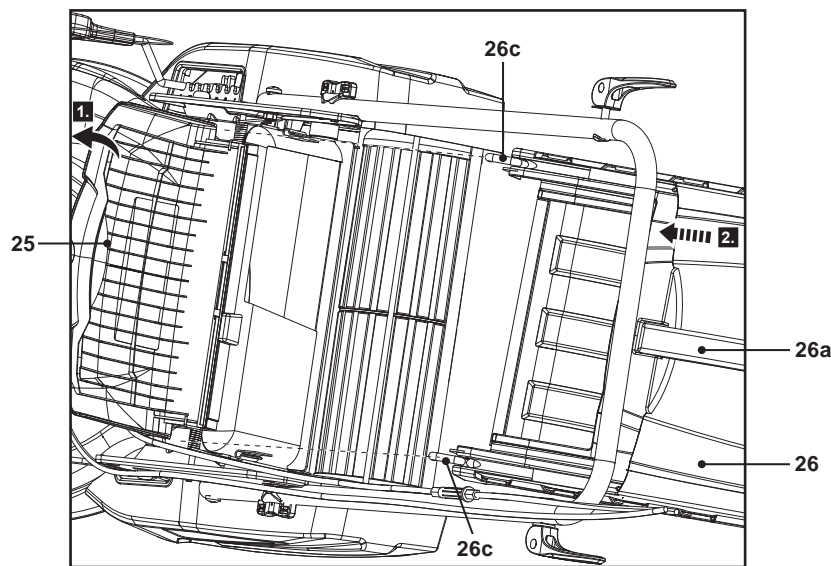

Fig. 6



**NOTE:**

Always carry the grass catcher (26) by its carry handle (26a).

**Fuel and engine oil**

This product is equipped with a 4-stroke engine. Before operation it is necessary to add proper fuel and engine oil separately.



**WARNING!** This product contains an instruction manual of the engine. Service the engine with proper petrol and engine oil as instructed in the separate engine handbook.



It is important to read and understand these instructions of the engine for its operations, maintenance, storage, etc.

SAVE THESE ORIGINAL INSTRUCTIONS FOR FUTURE REFERENCE.

1. Place the product on a stable, level surface. We recommend laying a non-flammable sheet under the product.
2. Use proper funnels. Avoid spilling and overfilling the tanks.



**WARNING!** Fuel and oil are highly inflammable! Fumes will explode if lit! Ensure that there are no naked flames around the product! Do not smoke while filling fuel and oil!



3. Always dispose of fuel, used oil and objects contaminated with them in accordance with local regulations.

**Fuel**



**NOTE:** This product is not supplied with fuel! Before operating this product it is essential to fill it with fuel! Fill fuel and engine oil separately. Never mix oil with petrol!



1. Always use clean, fresh unleaded petrol. Purchase fuel in quantities that can be used within 30 days.
2. Never mix oil with petrol. Avoid getting dirt, dust or water in the fuel tank.
3. Unscrew and remove the fuel tank cap (12) (Fig. 7).
4. Add suitable fuel into the fuel tank. Leave a minimum 5 mm of space between the top of the fuel and the inside edge of the tank to allow for expansion (Fig. 8).

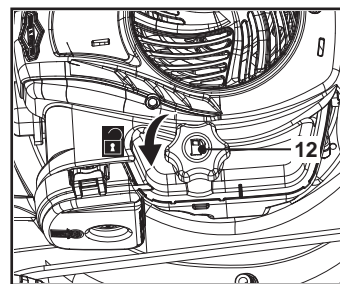

Fig. 7

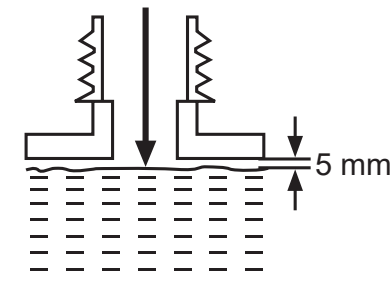

Fig. 8



**NOTE:** Petrol deteriorates over time. It may be difficult to start the engine if you use petrol which has been kept for more than 30 days.

Towards the end of the season, it is advisable to put only as much fuel in the tank as you need for each use, since it should be completely used up before storing the product.

Always empty the fuel tank when storing the product for over 30 days.

5. Wipe any spilled fuel with a soft cloth and reattach the fuel tank cap (12).

## Engine oil



**WARNING!** This product is not supplied with oil. However, for manufacturing reasons it is possible that a small quantity may be in the engine! Before operating this product it is essential to fill it with proper oil (4-stroke engine oil, e.g. SAE 10W-30)!

Engine oil has a major influence on engine performance and service life. Non-detergent or 2-cycle engine oils will damage the engine and should not be used!

1. Untighten and remove the oil tank cap (23) (Fig. 9).

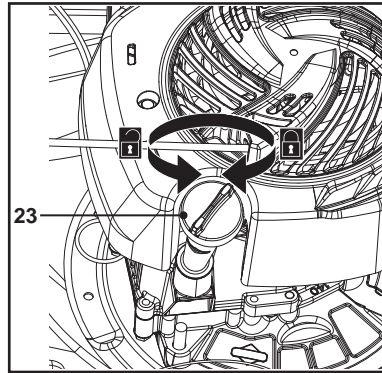

Fig. 9

2. Gradually add good-quality engine oil (SAE10W-30). Allow the oil to settle.
3. Check the oil level frequently while filling. Wipe the oil dipstick clean and insert it into the tank opening to the end with tightening the cap until it rests on the oil tank, and then remove the dipstick again.
4. The oil level must be between the "max" and "min" of the oil level markings. Add more oil if necessary. Do not overfill (Fig. 10).

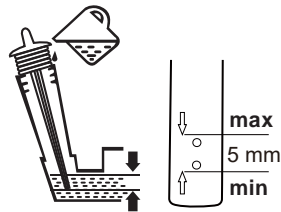
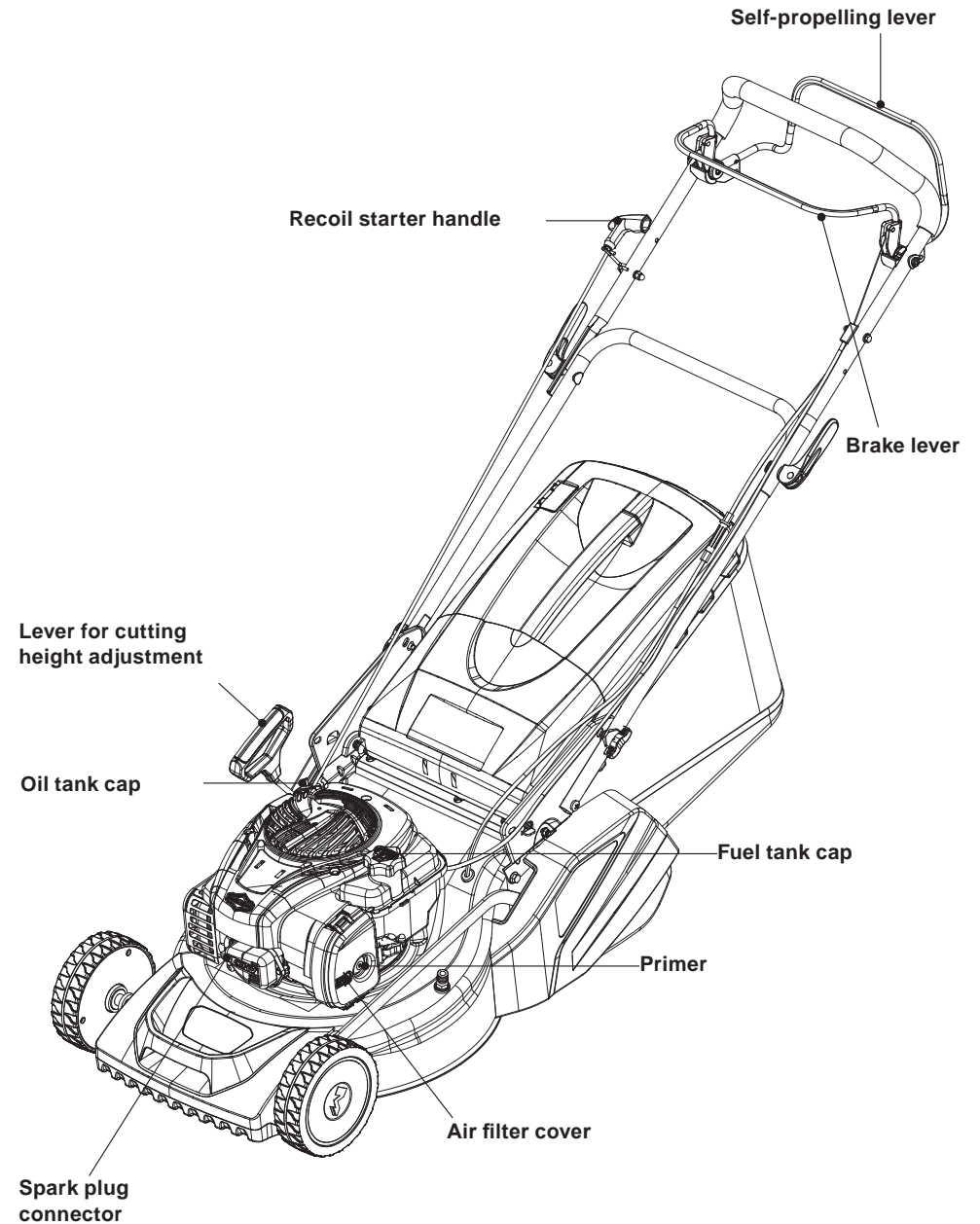

Fig. 10

5. After adding oil, wait a minute and then recheck the oil level.
6. Wipe spilled oil with a soft cloth and reattach the oil tank cap (23).

## EN Use

### Operating controls



## Set up



Assemble



Adjust



Add fuel



Add oil

## Start



Press the primer (15) 3 times for cold engine start



Pull back the brake lever (3) & hold it in position



Pull recoil starter handle (28), repeat until engine starts

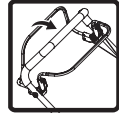

Push the self-propelling lever (2) & hold it in position



Operate

## Stopping

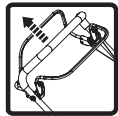

Release the self-propelling lever (2)



Release the brake lever (3)

## Storage



Empty fuel tank



Empty oil tank



Clean and maintain



Store



**WARNING!** This quick start provides only a short overview of how to start and stop the product! For safe use it is essential to read the entire instruction manual before first use!

## EN Functions & Settings

### Intended use

This petrol lawnmower MLMP500SP46-ROL is designated with a power output of 1.9 kW.

The product is intended for mowing grass in domestic gardens only. It must not be used to mow unusually high, dry or wet grass, e.g. pasture grass, or to shred leaves.

For safety reasons it is essential to read the entire instruction manual before first operation and to observe all the instructions therein.

This product is intended for private domestic use only, not for any commercial trade use. It must not be used for any purposes other than those described.

### Handle adjustment

Adjust the handle assembly (1, 8) to a suitable height according to your needs.

1. Hold the handle assembly (1, 8) with one hand.
2. Loosen the two locking knobs (9) 90° anti-clockwise from the handle brackets (10) and the lower handle bar (8) (Fig.11, step 1).
3. Swing the handle assembly (1, 8) to align the desired mounting holes (8a, 10a) of the lower handle bar (8) with the two handle brackets (10) (Fig. 11, step 2), then turn the two locking knobs (9) 90° clockwise.
4. If necessary, press the locking knob (9) to make sure that the auto-tension pin (9a) passes through the mounting holes (8a, 10a) of the lower handle bar (8) and handle bracket (10) on both sides (Fig. 11, step 3).

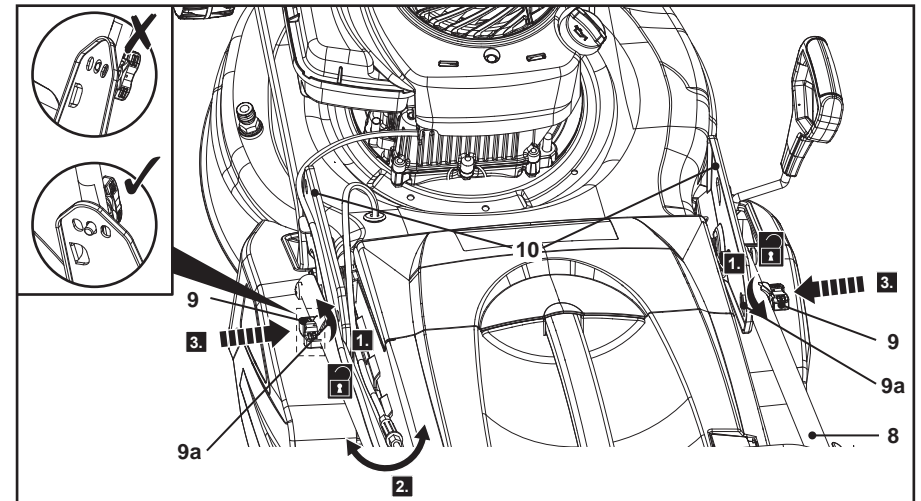

Fig. 11



## Brake lever

1. Pull back the brake lever (3) and hold it against the upper handle bar (1) when starting the engine. Keep it squeezed during operation (Fig. 12).
2. Release the brake lever (3) to stop the engine.

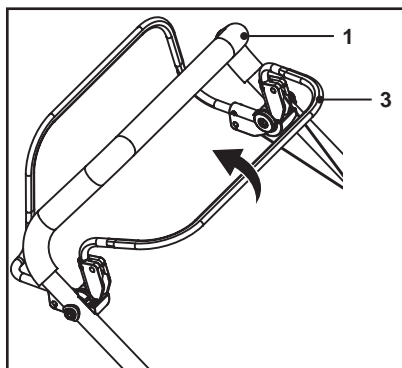

Fig. 12

## Recoil starter

The recoil starter handle (28) is positioned at the top of the engine.

1. Pull back the brake lever (3) and hold it against the upper handle bar (1) (Fig. 12).
2. Pull the recoil starter handle (28) lightly until you feel resistance then pull it rapidly. Do it repeatedly until the engine starts (Fig. 13).
3. Always rest the recoil starter handle (28) onto the hook (27) located on the right-hand side of the upper handle bar (1) (Fig. 14) when the recoil starter is not operated.

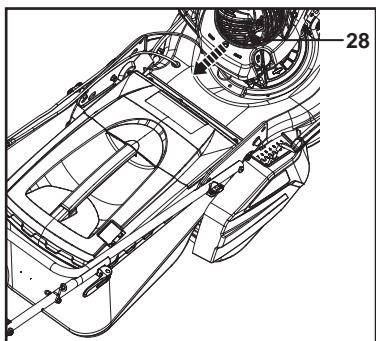

Fig. 13

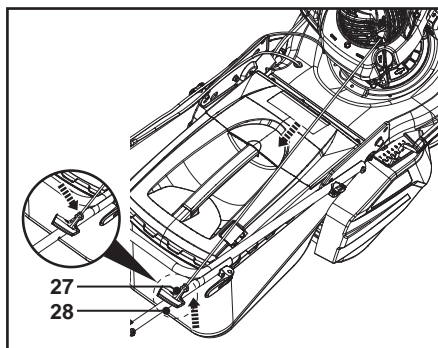

Fig. 14



**WARNING!** Never twist the starter cord around your hand! Only pull on the recoil starter handle (28)!

Do not suddenly release the recoil starter handle (28)! Allow the starter cord to return slowly and in a controlled manner each time it is pulled!

## Self-propelling lever

Use the self-propelled function as assistance during operation; the rear roller (31) are automatically driven by the engine; you do not need to push the product manually.

1. Push the self-propelling lever (2) forward and hold it against the upper handle bar (1) to engage the rear roller (31) (Fig. 15).
2. Release the self-propelling lever (2) to disengage the rear roller (31).

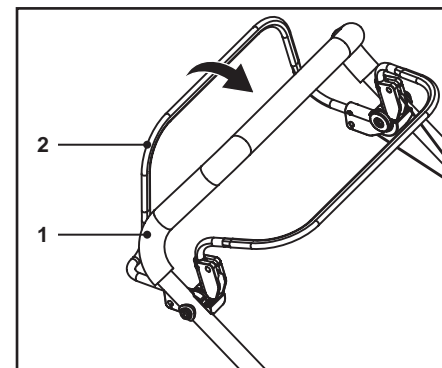

Fig. 15

## Rear roller

The wide rear roller (31) cuts right up to the edge of borders and create classic stripes so you'll achieve a beautiful finish to your lawn with ease (Fig. 16).

The lawn's appearance will be improved if it is always cut to the same height and is cut in alternate directions.

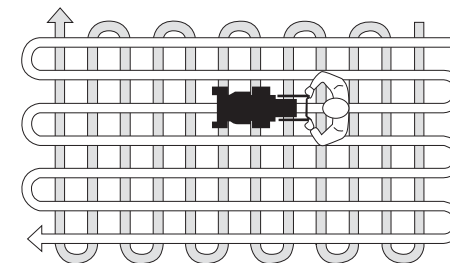
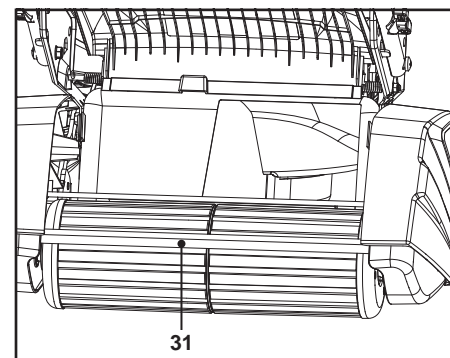

Fig. 16

## Grass catcher



**WARNING!** Do not attempt to use the product without the grass catcher attached when collecting grass - danger of flying objects!

Switch the engine off and wait that the blade had come to a complete stop before removing the grass catcher!



1. Always attach the grass catcher (26) when using the product for grass collection as described in the "Assembly - grass catcher" section.
2. Always carry the grass catcher by its carry handle (26a).

## Indicator

The grass catcher (26) is equipped with a hatch (26g) that indicates the filling during operation.

1. When the hatch (26g) is opened, the grass catcher (26) has sufficient volume left to collect grass (Fig. 17).
2. When the hatch (26g) is closed, the grass catcher (26) is full and must be emptied (Fig. 18).

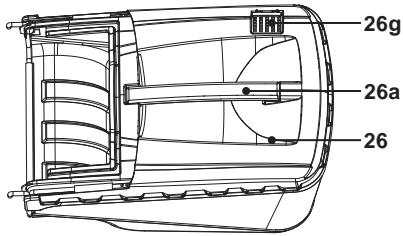

Fig. 17

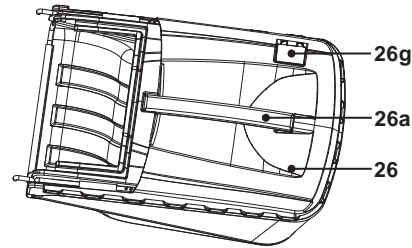

Fig. 18

## Emptying



**WARNING:** Switch the engine off and wait that the blade had come to a complete stop before removing the grass catcher (26)!

Empty the grass catcher (26) frequently during use. Do not wait until it is completely full. We recommend emptying when it is 90% full or the hatch (26g) is closed.



**NOTE:** A full grass catcher (26) will reduce the performance of this product.

1. Lift the rear deflector guard (25) and hold it in place.
2. Lift the grass catcher hooks (26c) off the spring rods and remove the grass catcher (26).
3. Remove the grass clippings from the rear discharge chute (30) into the grass catcher (26). Use a proper tool such as a brush.
4. Remove the grass catcher (26) by its carry handle (26a).
5. Empty the grass clippings onto a compost heap by its carry handle (26a) and bottom handle (26f).
6. Re-fit the grass catcher (26) onto the product and ensure the grass catcher hooks (26c) to stay correctly onto the spring rods as described in the "Assembly - grass catcher" section.



**WARNING!** Never use your hands or feet to remove grass clippings from the rear discharge chute (30)!



## Cutting height adjustment

Adjust the cutting height according to the needs of your lawn. The cutting height depends on the kind of lawn and its actual height. When mowing high grass, start with the maximum cutting height and make a second cut with a lower cutting height.

1. Pull the lever for cutting height adjustment (24) towards the roller deck (11) (Fig. 19, step 1), then move it forward or backward to the desired cutting height (Fig. 19, step 2).
2. Release the lever (24) and ensure it engages into place properly (Fig. 19, step 3).

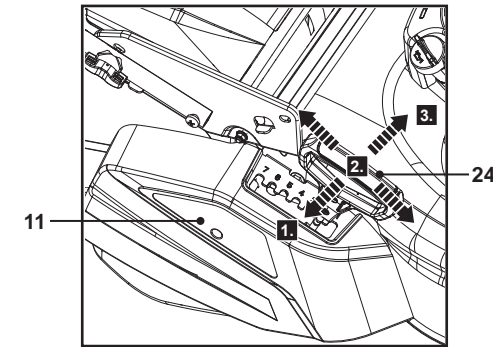

Fig. 19



**WARNING!** Ensure that the lever for cutting height adjustment (24) engages between two of the prongs!

Switch the engine off and wait that the blade had come to a complete stop before adjusting the cutting height!

## EN Operation

### General operation

1. Before each use:
  - Check the product and accessories for damage and whether they are properly fixed. Do not use the product if it is damaged or shows signs of wear and tear. Take care of any problem you find or have the product checked by qualified specialist.
  - Check the fuel and oil level. Refill if necessary.
  - Look around and underneath the product for signs of oil or fuel spill.
  - Check each control for proper operation.
  - Check the cutting blade (29) for wear.
  - Make sure that all bolts and screws are tightened.
  - Check if the air filter (16b) are clean.
2. Always push the product using the upper handle bar (1). Use the self-propelling function if required. Keep the handle bar dry and free from lubricant to ensure safe support.
3. Ensure that the air vents (13) are always unobstructed and clear. Clean them if necessary with a soft brush. Blocked air vents may lead to overheating and damage the product.
4. Stop the engine immediately if you are disturbed while working by other people entering the working area. Always let the product come to a complete stop before leaving the product unattended.
5. Do not overwork yourself. Take regular breaks to ensure you can concentrate on the work and have full control over the product.

## Starting/Stopping



**Warning!** Before starting, put the product on a flat surface free of high grass! Clean the underside of the deck!

Keep yourself ready! The product will start moving forward once you hold the self-propelling lever (2) towards the upper handle bar (1)! Start the engine carefully according to instructions. Keep your feet well away from the blade (29)!

Do not tilt the product when starting the engine.

## Start

1. Stand behind the upper handle bar (1).
2. Press the primer (15) 3 times if the engine is cold (Fig. 20, step 1). You can go directly to the next step if the engine is warm.
3. Pull back the brake lever (3) and hold it against the upper handle bar (1) (Fig. step 2).
4. Rest the recoil starter handle (28) onto the hook (27) located on the right-hand side of the upper handle bar (1).
5. Pull the recoil starter handle (28) lightly until you feel resistance then pull it rapidly. Do it repeatedly until the engine starts (Fig. 20, step 3).
6. When you are ready to mow, push the self-propelling lever (2) forward and hold it against the upper handle bar (1) (Fig. 20, step 4). The product starts moving forward and begins mowing.

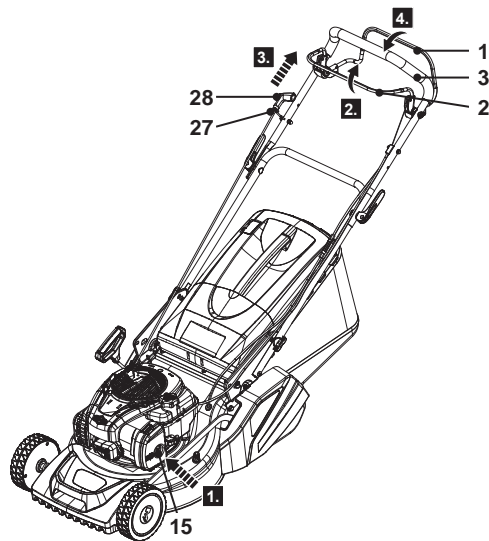

Fig. 20



**Warning!** The starting position should be as described in the instruction manual. Fig. 21 A illustrates the defined starting position. The operator should start the engine behind the upper handle bar (1). Do not start the engine while standing on the side of the product as shown on Fig. 21 B.

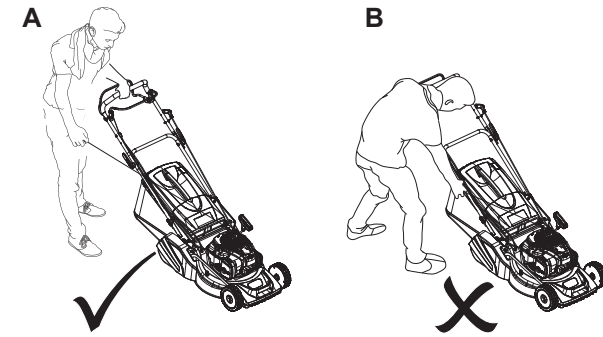

Fig. 21



**NOTE:** If the engine does not start, the engine may be flooded. Flooding is caused by too much fuel injected into the combustion chamber and can prevent a product from starting. Follow below procedure:

1. Remove the spark plug (21a) and dry it.
2. Pull the recoil starter handle (28) for several times to drain the fuel from the combustion chamber.
3. Wait until fuel vapours evaporate and refit the spark plug. Clean up any spilled fuel and move the product at least 3 metres (10') away before starting the engine to avoid any accidental fire. Wait for the engine to cool down then start the product as described in the "Start" section.

## Stopping

1. Release the self-propelling lever (2) to stop the self-propelled function (Fig. 22 step 1).
2. Release the brake lever (3) to stop the engine and blade (Fig. 22, step 2).

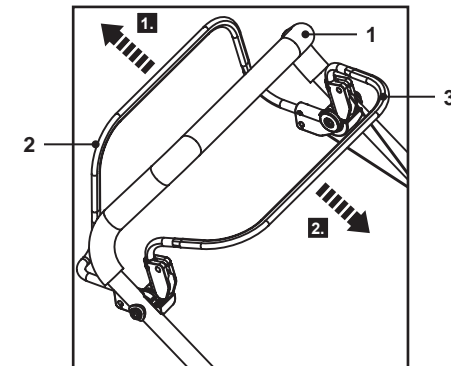

Fig. 22

## Mowing

1. Make sure that the lawn is clear of stones, toys, sticks, wire or other objects that could damage the product or its engine.
2. Do not cut wet grass because it tends to stick to the underbody of the product, preventing the proper discharge of grass clippings, and it could also cause you to slip and fall.
3. Never cut off more than one-third of the total length of the grass for a healthy lawn. In the autumn, lawns should only be cut as long as there is growth.
4. Slowly push the product forward. You may want to use the self-propelled function for assistance.
5. Mow in slight overlapping rows. The most effective pattern for mowing lawns is straight lines along one of the sides. This will keep the rows even and ensures that all the lawn is cut without missing any spots (Fig. 23).

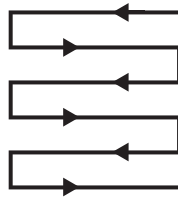

Fig. 23

6. Circle around flower beds. When reaching a flower bed in the middle of the lawn, cut a row or two around the circumference of the bed.
7. Pay special attention when changing direction.
8. Empty the grass catcher (26) regularly.



**WARNING!** If the product strikes a foreign object stop immediately! Let the product cool down and thoroughly inspect the product for damage! Have any damage repaired before restarting!



Extensive vibration of the product during operation is an indication of damage!



Stop the engine immediately. The product should be promptly inspected and repaired!

## After use

1. Stop the engine, disconnect the spark plug connector (21) and let it cool down.



**WARNING!** The spark plug (21a) will stay hot for a longer period of time after operation!

2. Check, clean and store the product as described below.

## EN Care and maintenance

### The golden rules for care



**WARNING!** Proper maintenance is essential for safe and trouble free operation. Improper maintenance, or failure to address a problem instantly can cause a malfunction which can result in serious injury or even death.



**WARNING!** Always stop the engine, disconnect the spark plug connector (21) and let the product cool down before performing inspection, maintenance and cleaning work!



DO NOT touch a rotating blade (29).

1. Keep the product clean. Remove debris from it after each use and before storage.
2. Regular and proper cleaning will help ensure safe use and prolong the life of the product.
3. Inspect the product before each use for worn and damaged parts. Do not operate it if you find broken and worn parts. Replace worn parts as necessary or contact an authorised service centre for repair before using the product again.



**WARNING!** Only perform repairs and maintenance work according to these instructions! All further works must be performed by a qualified specialist!

### General Cleaning

1. Clean the product with a slightly damp cloth and mild soap. Use a brush for areas that are hard to reach.
2. In particular clean the air vents (13) after every use with a cloth and brush.
3. Remove stubborn dirt with high pressure air (max. 3 bar).



**NOTE:** Do not use chemical, alkaline, abrasive or other aggressive detergents or disinfectants to clean this product as they might be harmful to its surfaces.

4. Check for worn or damaged parts. Replace worn parts as necessary or contact an authorised service centre for repair before using the product again.

### Thorough cleaning

1. Carry out the water supply deck cleaning in a flat area with good water drainage. Connect a garden hose to the water inlet (14) on the mower deck (Fig. 24).
2. Set the mower cut height to the highest position. Only clean with the product in the normal working position. Do NOT tilt or support the mower above the ground. Turn the water on.
3. Pull the brake lever (3) and hold it against the upper handle bar (1), then pull the recoil starter handle (28) lightly to start the engine and cutting blade (29).
4. Stop the engine by releasing the brake lever (3) when no further dirty water or debris can be seen exiting the underside of the product.
5. Dry the product with suitable cloths or paper towel. Wipe over the inside of the deck and blade with spray lubricant to prevent corrosion.

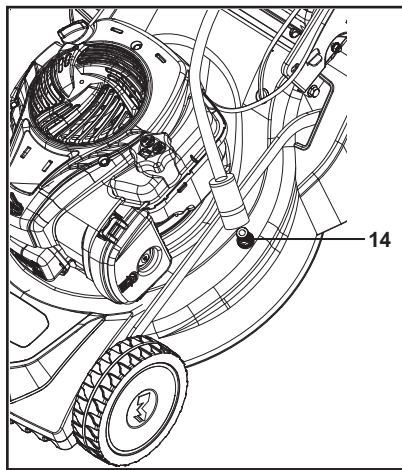

Fig. 24

## Maintenance

Before and after each use, check the product and accessories (or attachments) for wear and damage. If required, exchange them for new ones as described in this instruction manual. Observe the technical requirements.



**WARNING!** It requires to tip the product when performing maintenance, therefore the fuel tank must be empty otherwise the fuel can leak out and result in a fire or explosion.



**NOTE!** Always empty the fuel tank and keep the air filter (16b) / the spark plug (21a) upside. Otherwise the fuel or engine oil will contaminate them and cause difficulties to start the engine.

## Maintenance table

Part	To do	Before/ after each use	First month or 5 hours	Every 3 months or 25 hours	Every 6 months or 50 hours	Every year or 100 hours	Every 2 years or 250 hours
Engine oil	check	x					
	replace				x		
Air filter	check	x					
	clean			x			
	replace						x

Part	To do	Before/ after each use	First month or 5 hours	Every 3 months or 25 hours	Every 6 months or 50 hours	Every year or 100 hours	Every 2 years or 250 hours
Spark plug	check/ adjust			x			
	clean			x			
	replace						x
Spark plug cap	clean					x	
Fuel tank and filter	clean			x			
Fuel tube	clean	Every 2 years (replace if necessary)					
Valve clearance	check/ adjust					x	
Muffler	check					x	
	clean					x	
	replace					x	
Com- bustion chamber	clean	Every 200 hours					
Flywheel brake pad	check				x		

## Underbody and cutting device



**WARNING!** Wear protective gloves when working on the cutting device (29) and close to it! Use proper tools to remove debris, e. g. a wooden stick! Never use your bare hands!



Always use original spare parts for replacement. The cutting device (29) must be replaced by an identification no. ref. 2105200347. Do not attach any other type of cutting device!

The replacement of the cutting device (29) should be done by an experienced user! Rework or sharpening blades is not recommended unless it is done by a repair service or a similarly qualified specialist!



**NOTE:** We strongly recommend jacking the product when performing inspection and work on the cutting device (29). Avoid tilting the product in order to prevent fuel and oil leakages.

1. Keep the underbody and cutting device (29) clean and free of debris. Remove clippings from the rear discharge chute (30).

2. Check all nuts and bolts periodically for tightness before operation. After prolonged use, especially in sandy soil conditions, the cutting device (29) will become worn and lose some of the original shape. The cutting efficiency will be reduced and the cutting device should be replaced.
3. Keep the cutting device (29) sharp to ensure a good cutting performance. Replace a worn or damaged cutting device with a new one of the same type or have it sharpened by a qualified specialist.
4. If jacking the product is not possible, tilt it to the right side so that the fuel tank cap (12) side is up. This helps to prevent fuel leakage and harder starting due to flooding of the carburetor (17).
5. Loosen the hex bolt (29f) anticlockwise using a suitable wrench (Size 17mm) and remove it together with the cup washer (29e), the locking flange (29d), the cutting device (29), the blade holder (29c) from the spindle (29a) (Fig. 25).
6. Refit the blade holder (29c) together with the inner bushing (29b) onto the spindle (29a) and hold the assembly in position.
7. Replace the cutting device (29) with a new one of the same type. Check the status of the flange onto the blade holder (29c), attach the cutting device (29) properly, then attach the locking flange (29d) and ensure the two pins located into the groove of the flange of the blade holder (29c), fix the assembly with the cup washer (29e) and hex bolt (29f). Tighten the hex bolt (29f) clockwise with 40-45 Nm to ensure safe operation of your product (Fig. 25).

**WARNING!** Before fitting the cutting device (29), making sure that the blade's wings are facing toward the interior of the blade deck.

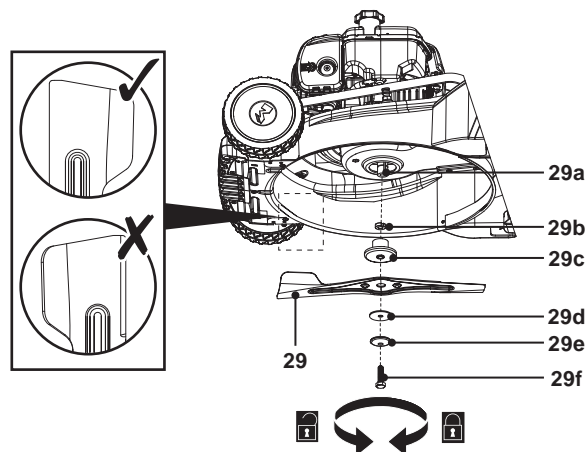

Fig. 25

**DANGER!** If the cutting device (29) are not torqued properly, they could become loose and be thrown from the product and seriously hurt or kill the operator or bystanders.

**NOTE:** Replace this cutting device (29) after 50 hours mowing or 2 years whichever is sooner regardless of condition. If the cutting device (29) is cracked or damaged, you must immediately replace it with a new one.

8. Lubricate the cutting device (29) after each use to prolong the life span of both the cutting device and product. Apply lubrication oil/grease along the edges of the cutting device (29).

## Grass catcher

1. Inspect the grass catcher (26) before each use. Do not use it if you find any damage.
2. Clean the grass catcher (26) after operation using water and mild soap.
3. Let the grass catcher (26) dry thoroughly before storing to avoid mildew.

## Wires

1. Check the performance of the brake wire (5) and the self-propelling wire (6) before each use. Ask a qualified specialist to adjust it if necessary.



**WARNING!** Do not use the product with defective or loose wires!

## Air filter



**NOTE:** A properly maintained air filter (16b) helps to prevent dirt from entering the engine. Entering dirt can cause blockages that can lead to premature engine wear or problems with starting or running the engine.

Wash the air filter (16b) every 25 hours (in dusty conditions or when airborne debris is present, clean more often).

1. Inspect the air filter (16b) regularly. Replace it with a new one if necessary.
2. Disengage the two locking latches (16a) and remove the air filter cover (16) afterwards (Fig. 26).
3. Remove the air filter (16b) and tap it on a solid surface to remove dust.
4. Apply a small amount of foam air filter oil on the air filter (16b) to increase its performance. Wipe out surplus oil and refit the air filter (16b) back into the air filter case.
5. Close the air filter cover (16) and ensure the two locking latches (16a) lock properly.

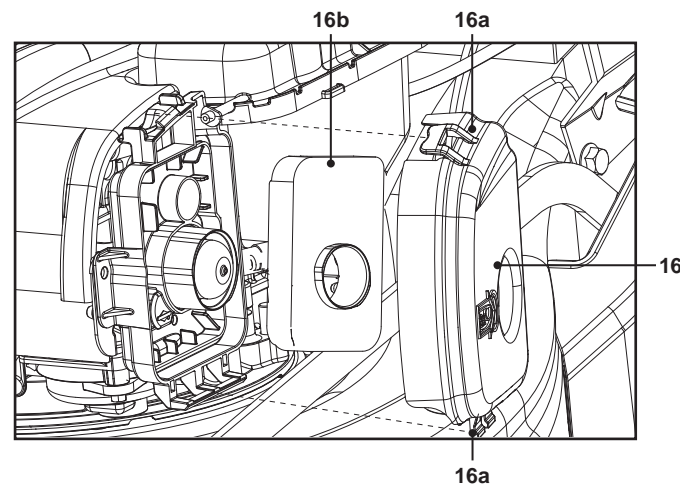

Fig. 26

## Spark plug



**NOTE:** For good performance, the spark plug (21a) must be properly gapped and free of deposits.

Inspect the spark plug (21a) every 25 hours or before long-term storage over 180 days. Clean or replace with a new one if necessary (type: XC92YC).

1. Disconnect the spark plug connector (21) (Fig. 27).
2. Loosen the spark plug anti-clockwise using the spark plug wrench (32) and remove it carefully (Fig. 28).



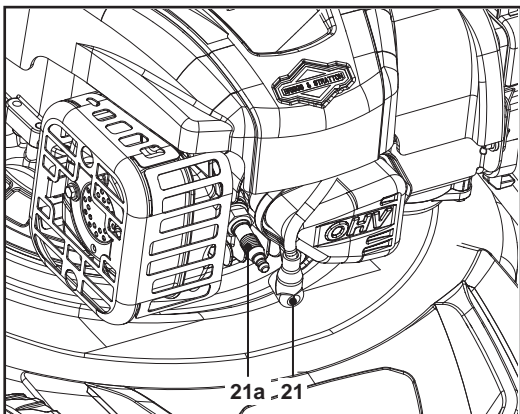

Fig. 27

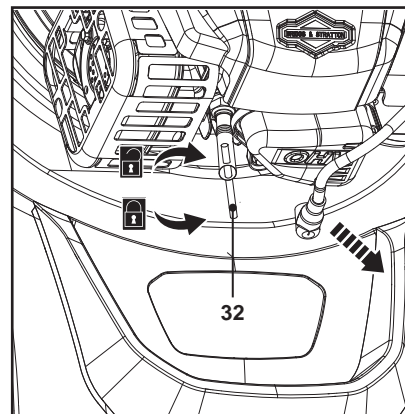

Fig. 28

3. Check the spark plug (21a) for damage and wear. The colour of the electrode should be light-brown.
4. Remove the deposits from the electrode with a soft wired brush. Avoid heavy cleaning of the electrode.
5. Dry the spark plug (21a) with a soft cloth, if it is wet from fuel.
6. Check the spark plug gap. It should be 0.7-0.8 mm (Fig. 29).
7. Replace with a new spark plug if either the electrode or the insulation is damaged.
8. When replacing the spark plug (21a), first screw it in hand tight and then tighten it to 20-25Nm with the spark plug wrench (32).

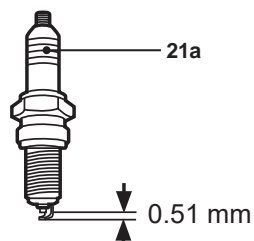

Fig. 29



**WARNING!** Do not overtighten the spark plug (21a) to avoid any damage!

## Fuel



**NOTE:** Petrol deteriorates over time. Engine starting may be difficult if you use petrol kept for more than 30 days.

1. Empty the fuel tank when storing the product over 30 days to prevent the fuel deteriorating.
2. Place a suitable container under the fuel drain screw (17a) to collect the fuel.
3. Unscrew the fuel drain screw (17a) and let the fuel run into the container (Fig. 30).
4. Screw the fuel drain screw (17a) back in and tighten it.
5. Wipe spilt fuel up.
6. Before re-use, refill the fuel tank as described in the "Fuel and engine oil - Fuel" section.

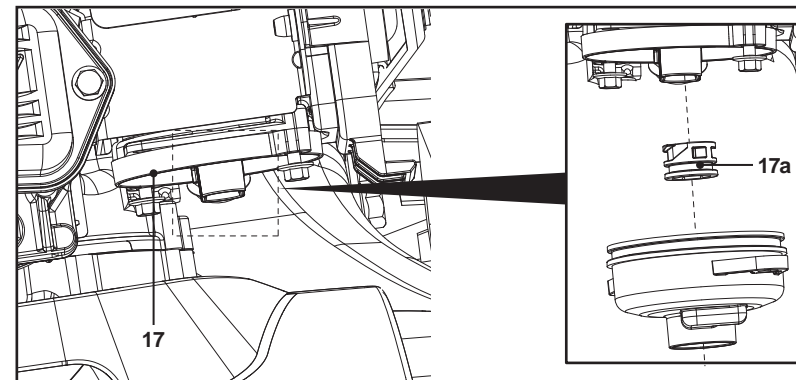

Fig. 30

## Checking engine oil



**NOTE:** Check the oil level and quality before each use.

The oil must be replaced after every 6 months or after 50 hours of operation.

1. Unscrew and remove the oil tank cap (23).
2. Gradually add good-quality engine oil (SAE 10W-30). Allow the oil to settle.
3. Check the oil level frequently while filling. Wipe off oil dipstick and insert it into the tank opening to the end, and then remove the dipstick again.
4. The oil level must be between the oil level markings (approx. 500 ml). Add more oil if necessary. Do not overfill.
5. After filling oil, wait 1 minute and then recheck the oil level.
6. Wipe the spilt oil with a soft cloth and reattach the oil tank cap (23).

## Draining engine oil



**NOTE:** Drain the oil every 50 hours of operation of every 6 months.



**WARNING!** Before tilting the product for maintenance, the fuel tank must be empty, otherwise the fuel can leak out and result in a fire or explosion!

1. The oil should be clear and thick. If the oil is sticky or contains dirt particles, draining the oil is necessary.
2. Unscrew the oil tank cap (23).
3. Place a suitable container next to the product to collect the drained oil. Ensure the container has an efficient volume.
4. Tilt the product to the side to drain the oil into the oil container.
5. Wipe spilled oil up.
6. Refill the oil tank as described in the "Fuel and engine oil - Engine Oil" section.

## Carburettor

The carburettor (17) is preset by the manufacturer. Should it be necessary to make any changes, contact an authorised service center or a similarly qualified specialist. Do not attempt to make any adjustments by yourself.

## Muffler

Should it be necessary to modify or replace the muffler (22), contact an authorised service center or a similarly qualified specialist. Do not attempt to make any adjustments by yourself.

## Valve play

Have a qualified specialist check and adjust the valve play. Details for the specialist:  
**IN** = 0.1-0.15 mm, **EX** = 0.1-0.15 mm.

## Spare parts/Replacement parts

The following parts of this product may be replaced by the consumer. Spare parts are available at an authorised dealer or through our customer service.

Description	Model no. or Specification
Spark plug (21a)	XC92YC / 797429
Cutting blade (29)	2105200347

## Repair



**NOTE:** Adjustment of the self-propelling wire (6) may be necessary as it may stretch over time.

If the rear roller (31) do not rotate when operating the self-propelling lever (2), it may be necessary to adjust the self-propelling wire (6) (Fig. 31).

1. Ensure that the upper locking nut (6a) is held steady by the spanner (size: 12 mm), then turn the lower sleeve (6b) anticlockwise to loosen it by hand.
2. Continue to turn the lower sleeve (6b) anticlockwise (downward) and leave 3-5 threads.
3. Ensure that the lower sleeve (6b) is held steady by hand, then use the spanner (size: 12 mm) to turn the upper locking nut (6a) in clockwise to tighten it.

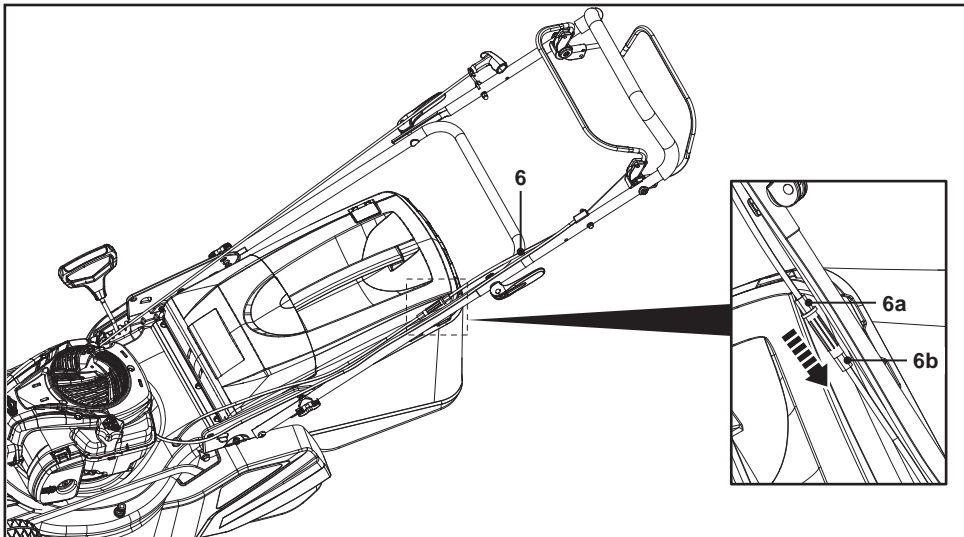

Fig. 31

If this problem cannot be solved, please contact an authorized service centre or qualified personnel for inspection and repair.

This product does not contain any other parts that can be repaired by the consumer.

## Storage



**NOTE:** Good storage conditions are important for keeping your product trouble free.

1. Stop the engine and disconnect the spark plug connector (21).
2. Clean the product as described in the "Cleaning" section.
3. Store the product and its accessories in a dry, frost-free, well-ventilated place.
4. Always store the product in a place that is inaccessible to children. The ideal storage temperature is between 10°C and 30°C.
5. We recommend using the original package for storage or covering the product with a suitable cloth or enclosure to protect it against dust.
6. Empty the fuel tank if you are not going to use the product for an extended period of time (more than 30 days) and before storing it for the winter.

## Transportation

1. Stop the engine and disconnect the spark plug connector (21).
2. Adjust the cutting height to the highest position as described in the "Cutting height adjustment" section.
3. Attach transportation guards, if applicable.
4. Always transport the product by the upper handle bar (1) and the transport handle (19).
5. If a suitable loading ramp is not available, ask another person for assistance when loading the product on a vehicle.
6. Protect the product from any heavy impact or strong vibrations which may occur during transportation in vehicles.
7. Secure the product to prevent it from slipping or falling over, loss of fuel, damage and injury.

## Troubleshooting

Suspected malfunctions are often due to causes that the users can fix themselves. Therefore check the product using this section. In most cases the problem can be solved quickly.



**WARNING!** Only perform the steps described within these instructions! All further inspection, maintenance and repair work must be performed by an authorised service centre or a similarly qualified specialist if you cannot solve the problem yourself!

Problem	Possible cause	Solution
1. Engine does not start	1.1. Not enough fuel in fuel tank	1.1. Add fuel
	1.2. Spark plug is wet	1.2. Dry spark plug
	1.3. Spark plug is damaged	1.3. Replace spark plug
	1.4. Spark plug connector is loose	1.4. Attach properly
	1.5. Air filter is dirty	1.5. Clean air filter
	1.6. Spark plug is loose	1.6. Tighten spark plug 20-25 Nm
	1.7. Spark plug gap is incorrect	1.7. Set gap between electrodes at 0.7 to 0.8 mm

Problem	Possible cause	Solution
1. Engine does not start	1.8. Primer not pressed before for cold engine	1.8. Press the primer for 3 times and restart
	1.9. Carburetor is flooded with fuel	1.9. Remove the spark plug and pull recoil starter handle continuously until carburetor clears itself
	1.10. Faulty ignition module	1.10. Contact an authorised service agent
2. Engine stops	2.1. Not enough fuel in fuel tank	2.1. Add fuel
	2.2. Cutting device is blocked	2.2. Remove blockage
3. Engine difficult to start or loses power	3.1. Dirt, water or stale fuel in the tank	3.1. Drain fuel and clean tank. Fill tank with clean, fresh fuel
	3.2. Vent hole in fuel tank cap is clogged	3.2. Clean or replace fuel tank cap
	3.3. Air filter is dirty	3.3. Clean air filter
	3.4. Primer not pressed before for cold engine	3.4. Press the primer for 3 times and restart
4. Engine operates erratically	4.1. Spark plug is defective	4.1. Install new, correctly gapped plug
	4.2. Spark plug gap is incorrect	4.2. Set gap between electrodes at 0.7 to 0.8 mm
	4.3. Air filter is dirty	4.3. Clean air filter
5. Engine idles poorly	5.1. Air filter is dirty	5.1. Clean air filter
	5.2. Air vents are clogged	5.2. Remove debris from vents
	5.3. Cylinder fins are blocked	5.3. Remove debris from cylinder fins
6. Engine skips at high speed	6.1. Gap between electrodes of spark plug is too close	6.1. Set gap between electrodes at 0.7 to 0.8 mm
7. Engine overheats	7.1. Air vents are clogged	7.1. Remove debris from vents
	7.2. Incorrect spark plug	7.2. Install correct spark plug and cylinder fins on engine
8. Unsatisfactory result	8.1. Cutting device is dull	8.1. Replace with a new one
	8.2. Cutting material exceeds capacity	8.2. Only cut materials acc. to the capacity of the product
	8.3. Cutting height is incorrect	8.3. Adjust cutting height
9. Excessive vibration/ noise or exhaust	9.1. Cutting device is dull/damaged	9.1. Replace with a new one
	9.2. Bolts/nuts are loose	9.2. Tighten bolts/nuts
	9.3. Petrol/oil type is incorrect	9.3. Drain the petrol/oil and refill with the correct petrol/oil

## Recycling and disposal

Old products are potentially recyclable and do not, therefore, belong in your household rubbish. You are requested to assist us and our contribution to saving resources and protecting the environment by handing in this product at an equipped collection centre (if there is one available).

Petrol, oil, used oil, a mixture of oil and petrol and objects soiled with oil e. g. cleaning cloths do not belong in the household rubbish. Dispose of oil-contaminated items in accordance with the local guidelines and hand them in at recycling centres.

The product comes in a package that protects it against damage during shipping. Keep the package until you are sure that all parts have been delivered and the product is function properly. Recycle the package afterwards.

## EN Guarantee

We take special care to select high quality materials and use manufacturing techniques that allow us to create products incorporating design and durability. This product has a manufacturer's guarantee of 2 years against manufacturing defects, from the date of purchase (if bought in store) or date of delivery (if bought online), at no additional cost for normal (non-professional or commercial) household use.

To make a claim under this guarantee, you must present your proof of purchase (such as a sales receipt, purchase invoice or other evidence admissible under applicable law), please keep your proof of purchase in a safe place. For this guarantee to apply, the product you purchased must be new, it will not apply to second hand or display products. Unless stated otherwise by applicable law, any replacement product issued under this guarantee will only be guaranteed until expiry of the original period guarantee period.

This guarantee covers product failures and malfunctions provided the product was used for the purpose for which it is intended and subject to installation, cleaning, care and maintenance in accordance with the information contained in these terms and conditions, in the user manual and standard practice, provided that standard practice does not conflict with the user manual.

This guarantee does not cover defects and damage caused by normal wear and tear or damage that could be the result of improper use, faulty installation or assembly, neglect, accident, misuse, or modification of the product. Unless stated otherwise by applicable law, this guarantee will not cover, in any case, ancillary costs (shipping, movement, costs of uninstalling and reinstalling, labour etc), or direct and indirect damage.

If the product is defective, we will, within a reasonable time, replace.

Rights under this guarantee are enforceable in the country in which you purchased this product. Guarantee related queries should be addressed to the store you purchased this product from.





The guarantee is in addition to and does not affect your statutory rights.

## Customer care and technical helpline

### A better way to repair your tools

Kingfisher takes special care in creating high-quality garden power tools that are designed to last. But if a fault develops with your garden power tool and you need to claim under the guarantee, the Customer Care and Technical Helpline can support with technical assistance or if required, arrange a free courier collection from your home, assess your garden power tool for fault, repair it, and return it.

Deciding to repair your product rather than buying a replacement and adding to the mountain of waste is a more sustainable choice and you will be doing your bit for the environment.

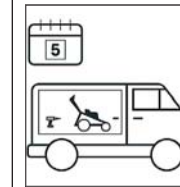
How does it work?				
				
Step 1	Step 2	Step 3	Step 4	Step 5
Find your proof of purchase and get in touch with the Customer Care and Technical Helpline.	Chat to them about the problem with your tool.	They will provide technical and user advice or alternatively arrange a courier collection from your home*.	The team will access and test and if necessary, repair your product back to full working order.	Your repaired tool will be returned to you via courier within 5 to 7 working days.



\* **NOTE:** Before collection, all fuel must be removed from petrol powered machines.

### Get in touch

If you need help or more information, please contact the Customer Care and Technical Helpline:

UK: 0800 0789647  
EIRE: 1800 932226

Opening hours are Monday – Friday, 8am-5pm

## Availability of spare parts

Contact the customer service helpline for assistance or visit [www.kingfisherspare.com](http://www.kingfisherspare.com)

For assistance contact the customer services helpline:

UK: 0800 0789647 [uk@kingfisherservice.com](mailto:uk@kingfisherservice.com)  
EIRE: 1800 932226 [eire@kingfisherservice.com](mailto:eire@kingfisherservice.com)

Further information about this product can also be found at:  
[www.kingfisher.com/products](http://www.kingfisher.com/products)

**UK  
CA**  
**(UK) DECLARATION OF CONFORMITY**

Product		
<ul style="list-style-type: none"> <li>Petrol lawnmower</li> <li>MLMP500SP46-ROL</li> <li>140cm<sup>3</sup>, 1.9kW, 46cm</li> <li>000001 - 999999</li> </ul>		
Name and address of the manufacturer or his authorised representative:		
Kingfisher International Products Limited 3 Sheldon Square London W2 6PX United Kingdom		
This declaration of conformity is issued under the sole responsibility of the manufacturer.		
Object of the declaration		
Product	Model	EAN
Petrol lawnmower	MLMP500SP46-ROL	5063022057501
The object of the declaration described above is in conformity with the relevant legislation:		
Supply of Machinery (Safety) Regulations 2008 as amended Noise Emission in the Environment by Equipment for Use Outdoors Regulations 2001 as amended The Non-Road Mobile Machinery (Type-Approval and Emission of Gaseous and Particulate Pollutants) Regulations 2018 as amended Electromagnetic Compatibility Regulations 2016 as amended The Restriction of the use of Certain Hazardous Substances in Electrical and Electronic Equipment Regulations 2012 as amended		
Measured Sound Power Level: 94.2 dB(A) Guaranteed Sound Power Level: 96 dB(A) Engine Model: 09P8(B&S500E) Approved Body 0168, TUV SUD BABT Unlimited • Octagon House, Concorde W • Hampshire PO 15 5RL • United Kingdom UKCA Certificate number: NE/005531/102; Report Number: 704032032130		
References to the relevant designated standards used or references to the other technical specifications in relation to which conformity is declared:		
EN ISO 5395-1:2013/A1:2018 EN ISO 5395-2:2013/A2:2017 EN ISO 14982:2009 EN ISO 3744:1995, ISO 11094:1991		
Authorised signatory and technical file holder:		
Kingfisher International Products Limited 3 Sheldon Square London W2 6PX United Kingdom		
		
David Awe Group Quality Director		
		On 2022-09-28





**(EN) EU DECLARATION OF CONFORMITY  
(FR) DÉCLARATION UE DE CONFORMITÉ  
(PL) DEKLARACJA ZGODNOŚCI UE  
(RO) DECLARAȚIA DE CONFORMITATE UE  
(ES) DECLARACIÓN UE DE CONFORMIDAD  
(PT) DECLARAÇÃO DE CONFORMIDADE UE**

Product/ Produit/ Produkt/Produsul/Producto/Produto

- Petrol lawnmower/Tondeuse à gazon thermique/Kosiarka spalinowa/Mașină de tuns iarba cu benzină/Cortacésped de gasolina/Cortador de grama a gasolina
- MLMP500SP46-ROL
- 140cm<sup>3</sup>, 1.9kW, 46cm
- 000001 - 999999

Name and address of the manufacturer or his authorised representative:

Nom et adresse du fabricant ou de son mandataire:

Nazwa i adres producenta lub jego upoważnionego przedstawiciela:

Denumirea și adresa producătorului sau a reprezentantului său autorizat:

Nombre y dirección del fabricante o de su representante autorizado:

Nome e endereço do fabricante ou do respetivo mandatário:

Kingfisher International Products B.V.,  
Rapenburgerstraat 175E,  
1011 VM Amsterdam,  
The Netherlands

This declaration of conformity is issued under the sole responsibility of the manufacturer.

La présente déclaration de conformité est établie sous la seule responsabilité du fabricant.

Niniejsza deklaracja zgodności wydana zostaje na wyłączną odpowiedzialność producenta.

Prezenta declarație de conformitate este emisă pe răspunderea exclusivă a producătorului.

La presente declaración de conformidad se expide bajo la exclusiva responsabilidad del fabricante.

A presente declaração de conformidade é emitida sob a exclusiva responsabilidade do fabricante.

Object of the declaration/Objet de la declaration/Przedmiot deklaracji/Obiectul declarației/Objeto de la declaración/Objeto da declaração

Product/Produit/Produkt/Produsul/Producto/Produto	Model/Modèle/Model/Modelul/Modelo/Modelo	EAN
Petrol lawnmower/Tondeuse à gazon thermique/Kosiarka spalinowa/Mașină de tuns iarba cu benzină/Cortacésped de gasolina/Cortador de grama a gasolina	MLMP500SP46-ROL	5063022057501

The object of the declaration described above is in conformity with the relevant Union harmonisation legislation:

L'objet de la déclaration décrit ci-dessus est conforme à la législation d'harmonisation de l'Union applicable:

Wymieniony powyżej przedmiot niniejszej deklaracji jest zgodny z odnośnymi wymaganiami unijnego prawodawstwa harmonizacyjnego:

Obiectul declarației descris mai sus este în conformitate cu legislația relevantă de armonizare a Uniunii:

El objeto de la declaración descrita anteriormente es conforme con la legislación de armonización pertinente de la Unión:

O objeto da declaração acima descrito está em conformidade com a legislação de harmonização da União aplicável:

2006/42/EC as amended Machinery Directive  
2014/30/EU as amended Directive Electromagnetic compatibility  
2000/14/EC as amended Outdoor Noise Directive  
2016/1628/EU Regulation Gaseous and Particulate Pollutant Emission Limits  
2011/65/EU as amended Directive Restriction of the use of certain hazardous substances in electrical and electronic equipment  
Directive 2006/42/CE relative aux machines  
2014/30 / UE telle que modifiée Directive Compatibilité électromagnétique  
Directive 2000/14/CE relative aux émissions sonores extérieures  
Règlement (UE) 2016/1628 relatif aux exigences concernant les limites d'émission pour les gaz polluants et les particules polluantes  
Directive 2011/65/UE relative à la limitation de l'utilisation de certaines substances dangereuses dans les équipements électriques et électroniques  
2006/42/WE w zmienionej dyrektywie maszynowej  
2014/30 / UE ze zmianami Dyrektywa Kompatybilność elektromagnetyczna  
2000/14/WE w zmienionej dyrektywie w sprawie hałasu na zewnątrz  
2016/1628/UE limity emisji zanieczyszczeń gazowych i cząstek stałych  
2011/65 / UE ze zmianami Dyrektywa Ograniczenie stosowania niektórych niebezpiecznych substancji w sprzęcie elektrycznym i elektronicznym  
2006/42/CE, astfel a fost modificată Directiva privind echipamentele  
2014/30/UE, astfel a fost modificată Directiva privind compatibilitatea electromagnetică  
2000/14/CE, astfel a fost modificată Directiva privind zgomotul în aer liber  
2016/1628/UE Regulamentul privind emisiile de poluanți gazoși și de particule poluante  
2011/65/UE, astfel a fost modificată Directiva privind limitarea utilizării anumitor substanțe periculoase în echipamentele electrice și electronice  
Directiva sobre maquinaria modificada 2006/42/CE  
2014/30/UE modificada Directiva Compatibilidad electromagnética  
2000/14/CE modificada Directiva sobre ruido al aire libre  
2016/1628/Reglamento de la UE Límites de emisiones de contaminantes gaseosos y partículas  
2011/65/UE modificada Directiva Restricción del uso de determinadas sustancias peligrosas en equipos eléctricos y electrónicos  
2006/42/CE como diretiva de máquinas alteradas  
2014/30/UE como alteração da compatibilidade eletromagnética  
2000/14/CE como diretiva de ruído exterior alterada  
Limites de emissão de poluentes gasosos e de poluentes de partículas 2016/1628/REGULAMENTO da UE  
2011/65/UE como restrição diretiva alterada da utilização de certas substâncias perigosas em equipamentos elétricos e eletrônicos

Measured Sound Power Level

Le niveau de puissance acoustique mesuré

Zmierzony poziom mocy akustycznej

Nivel de putere acustică măsurat

Nivel de potencia sonora medido

Nível de potência sonora medido

: 94.2 dB(A)

Engine Model

Modèle de moteur

Model silnika

Modelul motorului

Modelo de motor

Modelo de motor

:09P8 (BS500E)

Guaranteed Sound Power Level

Le niveau de puissance acoustique garant

Gwarantowany poziom mocy akustycznej

Nivel de putere acustică garantat

Nivel de potencia sonora garantizado

Nível de potência sonora garantido

: 96 dB(A)

EC Type Approval No

Approbation de type CE Non

Homologacja typu WE nr

Nr. omologare CE de tip

No de homologación de tipo CE

Aprovação do tipo CE Não

: OR/005531/102



The notified body/ l'organisme notifié / Jednostka notyfikowana / Organismul notificat / Organismo notificado / Organismo notificado: TÜV SÜD Industrie Service GmbH, No 0036  
Certificate registration number/ Numéro d'enregistrement du certificate/Number rejestracyjny certyfikatu / Nr.de inregistrare a certificatului / Numero de registro del certificado / Numero do certificado de registo: OR/005531/102  
Test report No./ Numéro du rapport de test/ Numer raportu / Raport test nr. /N.0 del informe de prueba/ Ralatorio de teste no: 704032032130  
Conformity assessment procedures: Annex VI of the directive / Procédures d'évaluation de conformité : Annexe VI de la Directive/ Procedury oceny zgodności: Załącznik VI dyrektywy / Proceduri de evaluare a conformitatii: Anexa VI a directivei / Procedimientos de evaluacion de la conformidad : Anexo VI de la directiva / Procedimentos de avaliacao de conformidade: Anexo VI da diretiva

References to the relevant harmonised standards used or references to the other technical specifications in relation to which conformity is declared:

Références des normes harmonisées pertinentes appliquées, y compris la date de celles-ci, ou des autres specifications techniques, y compris la date de celles-ci, par rapport auxquelles la conformité est déclarée:

Odwołania do odnośnych norm zharmonizowanych, które zastosowano, wraz z datą normy, lub do innych specyfikacji technicznych, wraz z datą specyfikacji, w odniesieniu do których deklarowana jest zgodność:

Trimiteri la standardele armonizate relevante folosite, inclusiv data standardului, sau trimiteri la celelalte specificatii tehnice, inclusiv data specificatiilor, în legătură cu care se declară conformitatea:

Referencias a las normas armonizadas pertinentes utilizadas, incluidas las fechas de las normas, o referencias a las otras especificaciones técnicas, incluidas las fechas de las especificaciones, respecto a las cuales se declara la conformidad:

Referências às normas harmonizadas aplicáveis utilizadas, incluindo a data da norma, ou às outras especificações técnicas, incluindo a data da especificação, em relação às quais é declarada a conformidade:

EN ISO 5395-1:2013+A1:2018  
EN ISO 5395-2:2013+A1:2016+A2:2017  
EN ISO 14982:2009  
EN ISO 3744:1995, ISO 11094:1991

Authorised signatory and technical file holder/signataire et responsable de la documentation technique autorisé/ podmiot uprawniony do wystawienia i adres prezechowywania dokumentacji technicznej/ semnatar autorizat și deținător al dosarului tehnic/firmante autorizado y titular del expediente tecnico/ signatário autorizado e detentor da ficha técnica

Kingfisher International Products B.V.,  
Rapenburgerstraat 175E,  
1011 VM Amsterdam,  
The Netherlands

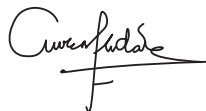

David Awe  
Group Quality Director

: 29/09/2022